

**SEA<sup>®</sup>**  
Sistemi Elettronici  
di Apertura Porte e Cancelli  
International registered trademark n. 804888



**English**

# LEPUS

*MOTOR REDUCER FOR SLIDING GATES*



SEA S.p.A.  
Zona industriale 64020 S.ATTO Teramo - (ITALY)  
Tel. +39 0861 588341 r.a. Fax +39 0861 588344

[www.seateam.com](http://www.seateam.com)  
[seacom@seateam.com](mailto:seacom@seateam.com)



## FITTING AND CONNECTION INSTRUCTIONS

**LEPUS** is an **oil-bathed motor-reducer** created for sliding gates automation. The motor-reducer **irreversibility** allows a perfect and safe gate closing avoiding the setup of an electrolock and in case of power supply lacking, the release device which is in the frontal part of the motor-reducer allows the manual opening and closing. The operator has a **mechanical adjustable clutch** which ensures the control of the gate pushing. Moreover, **the electronic reversing device** realized through an **encoder** makes the lepus motor-reducer a safe and reliable operator allowing in a simple way to comply with the current norms in the countries where this product is set up.

### MAIN PARTS NOMENCLATURE

- |                               |                                     |
|-------------------------------|-------------------------------------|
| 1 Adjustable Foundation plate | 6 Adjusting screw mechanical clutch |
| 2 Anchor bolts                | 7 Electronic control unit           |
| 3 Angular cover               | 8 Oil filling up cap                |
| 4 Pinion                      | 9 Magnetic encoder                  |
| 5 Lever release reducer       |                                     |

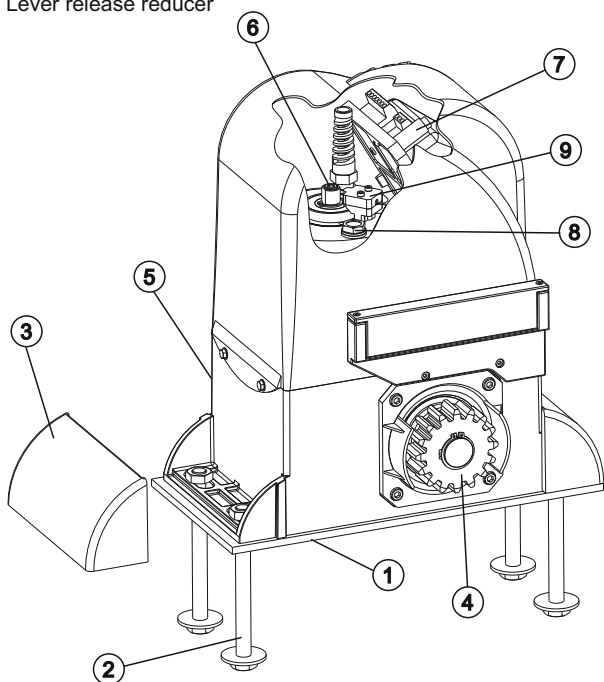

TECHNICAL DATA	600	600 Continuos	1600	2000 Three-Phase	2000 24V dc *
Power Supply	230V~ 50/60 Hz			230V/400V 50/60 Hz	24V
Power	330W		450W	650W	100W
Motor capacitor	25 µF		35 µF	-	-
Working Frequency	75% Intensive	90%	75% Intensive		
Motor rotation speed	1400 rpm				-
Reduction ratio	1/30				
Room temperature	-20°C ÷ +55°C				
Thermal protect. intervent.	130°C				-
Weight of the unit with oil	15 kg			15,5 kg	
Oil quantity	1,75 L.			1 L.	
Protection rating	IP 55				
Gate speed (pinion Z13)	-	-	-	-	0.23 m/s
Gate speed (pinion Z16)	0.175 m/s				-
Gate speed (pinion Z20)	0.2 m/s				-
Maximum torque	50 Nm	70Nm	90Nm		
Maximum weight of the gate	600 kg	1600 kg	2000 kg		
Anti-crushing clutch	Mechanical in oil bath - Electronic				Electronic
Limit switch	Mechanical with leve/Inductive				Mechanical with leve

\* Lepus 2000 24V no control unit

TECHNICAL DATA	LEPUS 110V
Power Supply	115 V~ (±5%) 50/60 Hz
Power	330W
Motor capacitor	80 µF
Working frequency	60%
Motor rotation speed	1550 rpm
Reduction ratio	1/30
Room temperature	-20°C ÷ +55°C
Thermal protection intervention	130°C
Weight of the unit with oil	15 Kg
Oil quantity	1,75 L.
Protection rating	IP 55
Gate speed (pinion Z16)	0.175 m/s
Gate speed (pinion Z20)	0.2 m/s
Maximum torque	60 Nm
Maximum weight of the gate	800 Kg
Anti-crushing clutch	Mechanical in oil bath - Electronic
Limit switch	Mechanical with leve/Inductive

**Note:** The frequency of use is valid only for the first hour at 20°C room temperature.

### LEPUS MOTOR-REDUCER USING-GRAPHIC

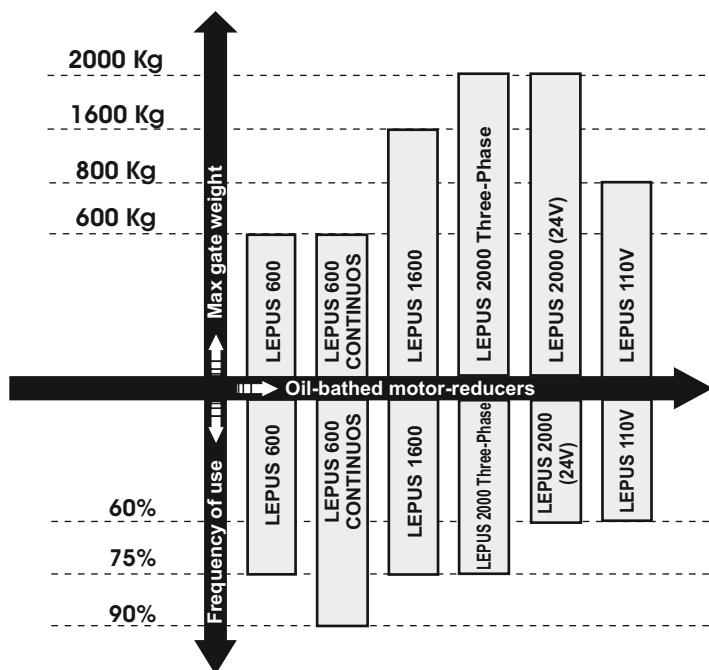

### DIMENSIONS (mm)

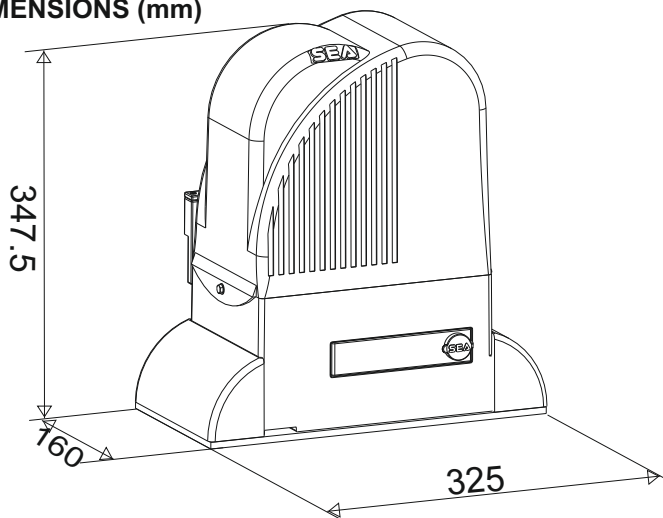



## 1. GATE ARRANGEMENT

The first thing to check is that the gate is in good running order as follows:

- The gate is rigid and straight and runs smoothly throughout its travel.
- The lower track is in good order, straight and levelled.
- The lower support wheels have sealed bearings or grease points.
- The top guide must be manufactured and installed so that the gate is perfectly upright.
- Physical gate stops must be fitted to prevent the gate coming out of its guides and track.

## 2. MOUNTING PLATE INSTALLATION

To install the mounting plate it is necessary to:

**2.1.** Have a mounting plate manufactured to the dimensions shown in Fig. 1. The plate will require to have concrete holding into which the foundation plate and the anchor bolts will be walled up.

**Note:** It is best if the gate structure allows the plate to be raised up from the finished level by 50 mm. This will stop water gathering around the operator.

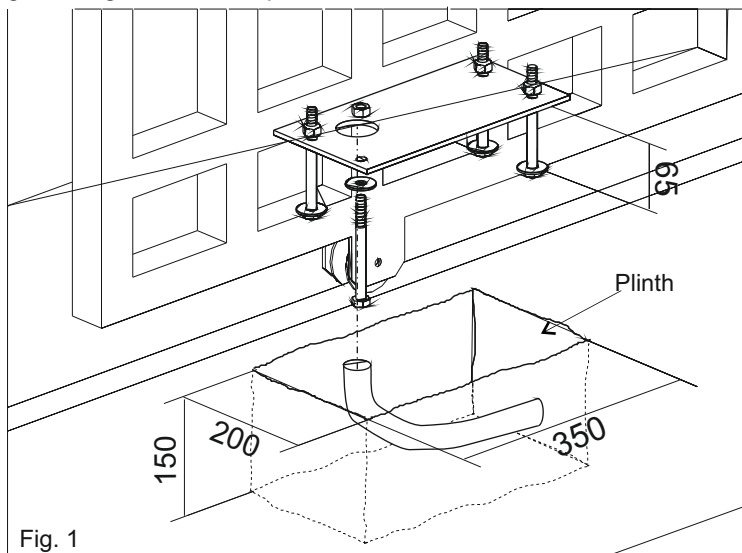

Fig. 1

**2.2.** When you are concreting in the plate install any necessary cable ducts (30 mm dia. minimum) and cables in through the base plate. Cable ducts should have sweep bends not elbow ones.

**2.3.** When concreting in the plate check that the plate is perfectly levelled and that the measurement of 50 - 55 mm given in Fig. 2 is followed.

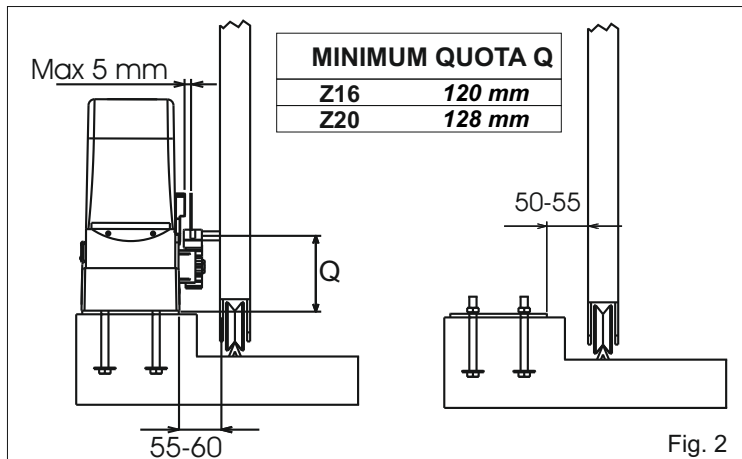

Fig. 2

## 3. PINION ASSEMBLING

**3.1.** Put the spline into the motor reducer shaft as in Fig. 3.

**3.2.** Mount the pinion on the motor as shown in fig.3

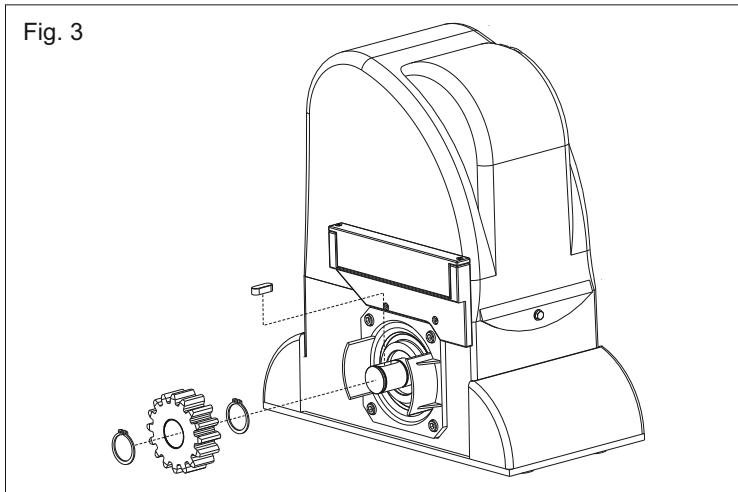

Fig. 3

## 4. FITTING OF THE UNIT

**4.1.** Fix the motor-reducer to the foundation plate adjusting the side position and its height (Fig. 4 - Fig. 5) considering the mentioned measurements in Fig. 2.

**4.2.** Remove the closing loading oil cap (red) and substitute it with that supplied apart provided with the airhole (black).

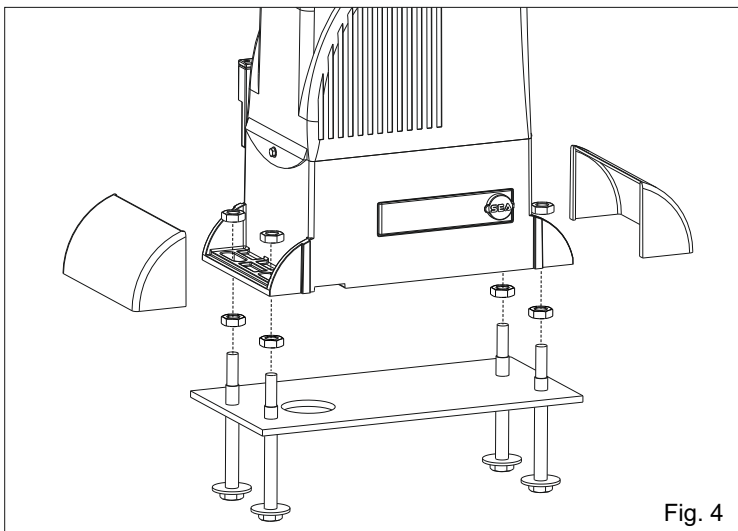

Fig. 4

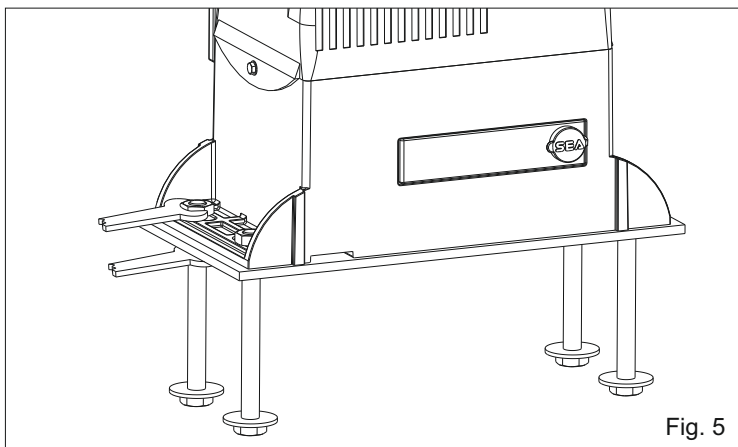

Fig. 5



## 5. GEAR RACK MOUNTING

**5.1.** Release the motor reducer and take the leaf to complete opening;

**5.2.** Fix to each gear rack element the support pawls using the appropriate lock screws, taking care to place them in the upper part of the hole (Fig. 6);

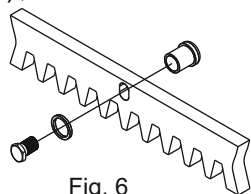

Fig. 6

**5.3.** Lean the gear rack element on the toothed pinion of the motor so that it results parallel to the ground sideway of the gate, place it as shown in Fig. 7 and electrically weld the central pawl B to the gate structure (Fig. 8).

Manually move the gate until pawl C is placed in correspondence to the pinion, now fix it with electric welding. Repeat the same procedure for pawl A after having placed it in correspondence to the pinion;

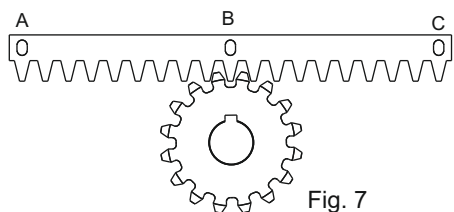

Fig. 7

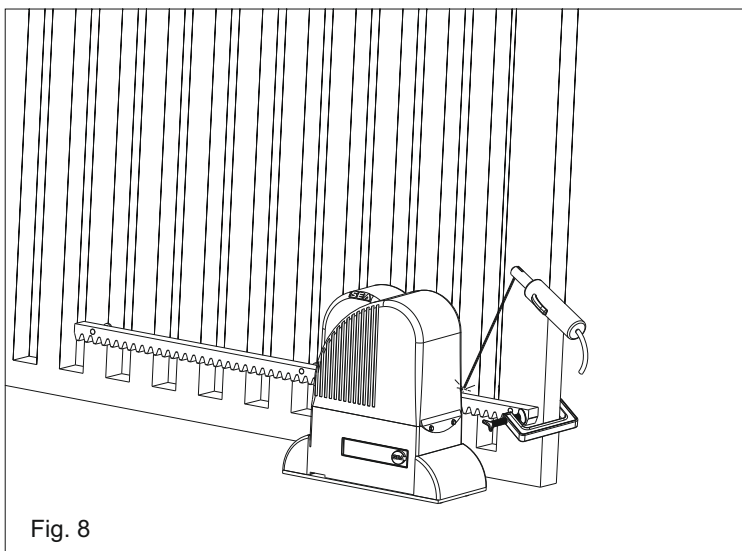

Fig. 8

**5.4.** Make sure that all the gear rack elements are perfectly aligned and placed correctly (teeth in phase). It's suggested to place two aligned elements in front of a third one as shown in Fig.9;

**5.5.** Repeat the above described operation for all the remaining gear rack elements which have to be installed;

**5.6.** To avoid that the door weights down on the pinion (Fig.10) lift up the whole rack about 1,5 mm.

**Warning:** Keep a gap of about 0,5 mm between pinion tooth and gear rack tooth;

**5.7.** Make sure that the gear rack works at the center of the pinion along all rack elements, if necessary, adjust the distance pieces length.

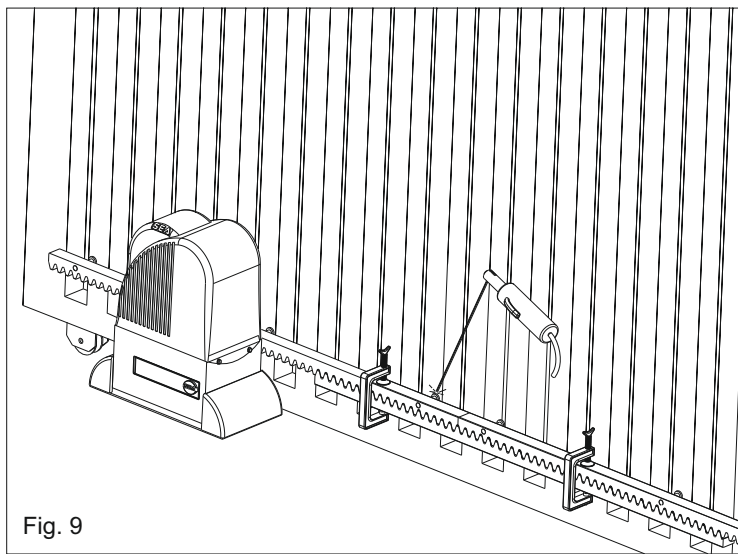

Fig. 9

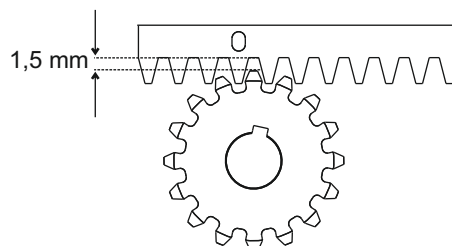

Fig. 10

## 6. LIMIT SWITCH ADJUSTMENT

**6.1.** To set up and adjust the limit switches in opening, follow the instructions written here (Fig. 11):

- Bring the gate in complete opening,
- Place the limit switch plate on the gear rack to have the limit switch (lever in case of mechanical limit switch (Fig. 12); pointers placed in the higher part in case of inductive limit switch (Fig. 13)) in correspondence with the X point which is 50 mm from the folded side of the plate (Fig. 14) and fix it with the supplied screws (Fig. 15).

**6.2.** To set up and adjust the limit switches in closing, follow the instructions written here (Fig. 11):

- Bring the gate in complete closing,
- Place the limit switch plate on the gear rack to have the limit switch in correspondence with the X point which is 50 mm from the folded side of the plate (Fig. 14) and fix it with the supplied screws (Fig. 15).

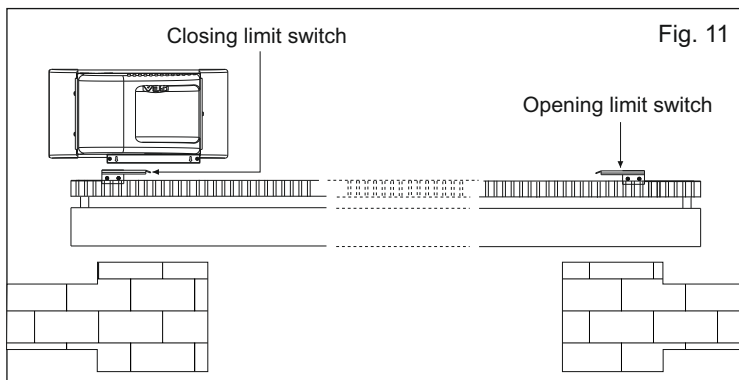

Fig. 11

### Mechanical limit switch

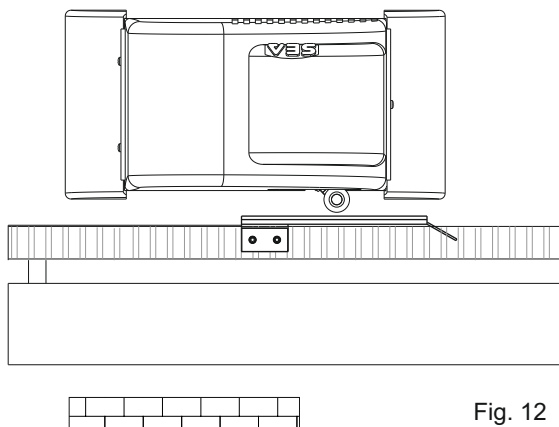

Fig. 12

### Inductive limit switch

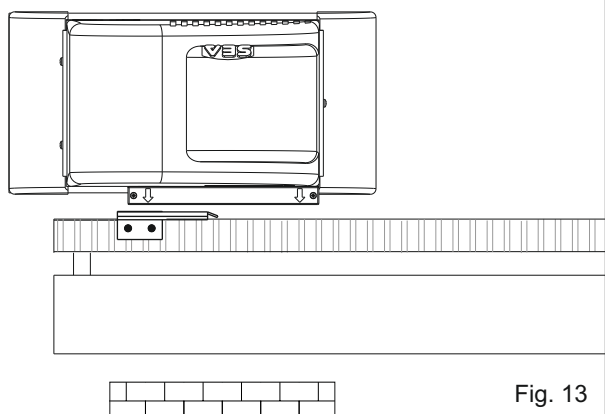

Fig. 13

Place where the wheel (mechanical limit switch) or the arrow (inductive limit switch) must be

50 mm

Fig. 14

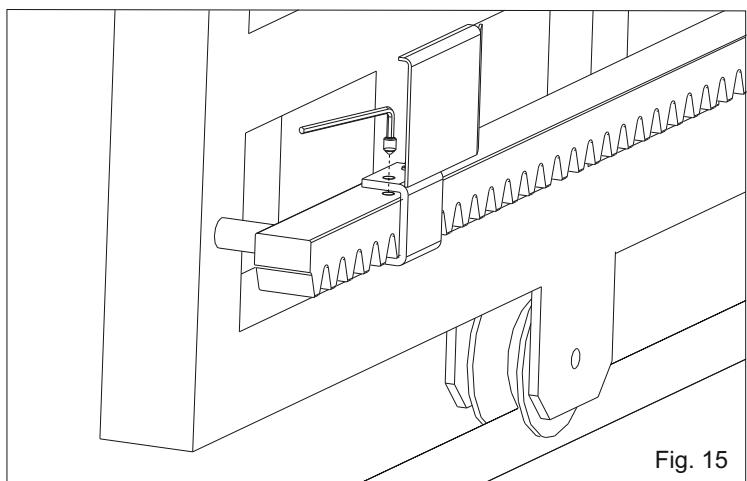
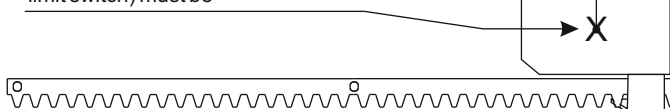

Fig. 15

Through the braking trimmer adjustment placed on the electronic control unit it is possible to stop the gate in the point desired.

## 7. GROUNDING (Fig. 16)

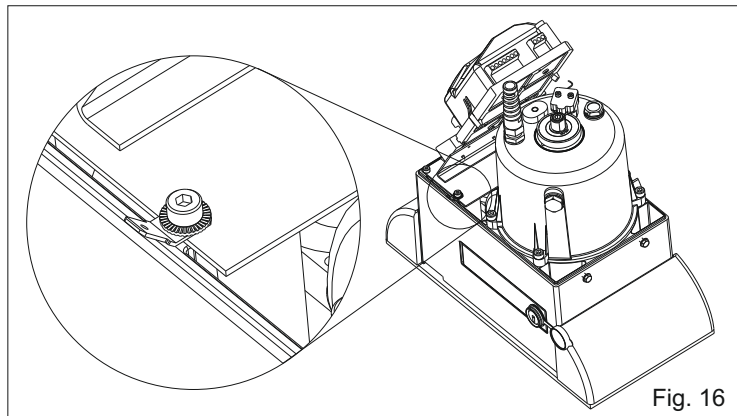

Fig. 16

## 8. CLUTCH ADJUSTMENT

8.1. Take power supply tension off.

8.2. To adjust the clutch act as follows:

- Act on the "A" screw (Fig. 17) in the following way:
- Clockwise = less clutch sensibility and more pushing force
- Anti-clockwise = more clutch sensibility and less pushing force

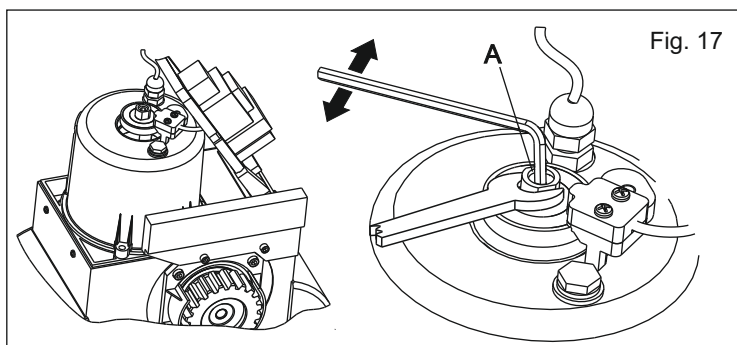
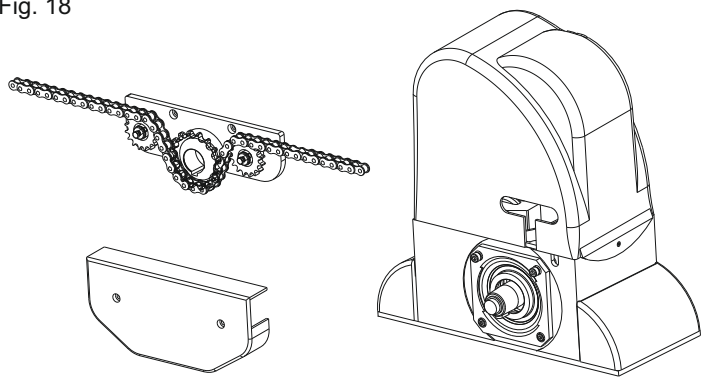

Fig. 17

## 9. ASSEMBLING OF THE CHAIN SYSTEM

The assembling of the main parts which include the whole chain automation is illustrated in Fig. 18.

Fig. 18



In the pictures 19 and 20 it is possible to see the correct installation with opened and closed gate respectively; notice the obliged run of the chain inside the pinion group which must not be modified.

For a correct installation follow carefully the indications written below:

9.1. Weld two strong pierced brackets to the two extremities of the gate to couple the chain.

**Notice: the holes for the chain tensioner and so the chain itself must be to a minimum distance of 45 mm from the gate (Fig. 21).**

**9.2.** Install the chain making it pass through the pinion group as in Fig. 18.

The chain must be always in line both vertically (Fig. 19) and horizontally (Fig. 21), if not perfectly aligned (Fig. 22 and 23) it may derail from the pinion group or the motor reducer risks a greater effort not allowing the right operating of the system.

**9.3.** Set up a fillet chain tensioner to the two extremities of the gate to regulate the tension of the chain.

**Notice: do this last operation with the engine completely unlocked through the special unlocking key.**

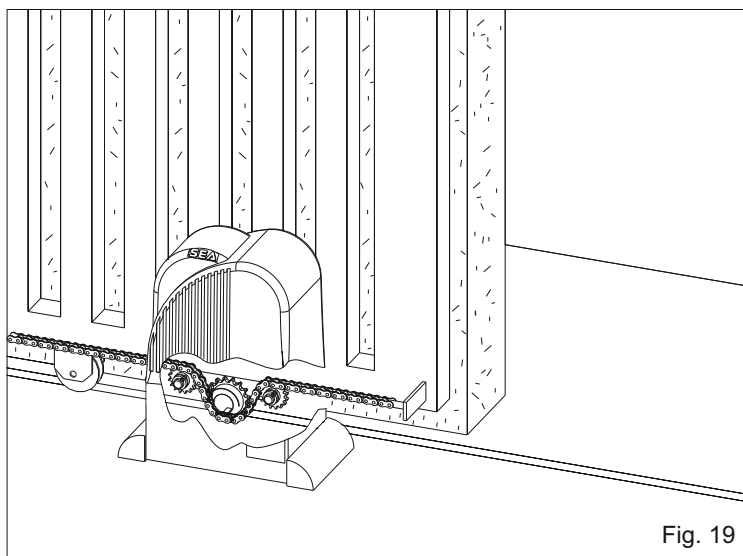

Fig. 19

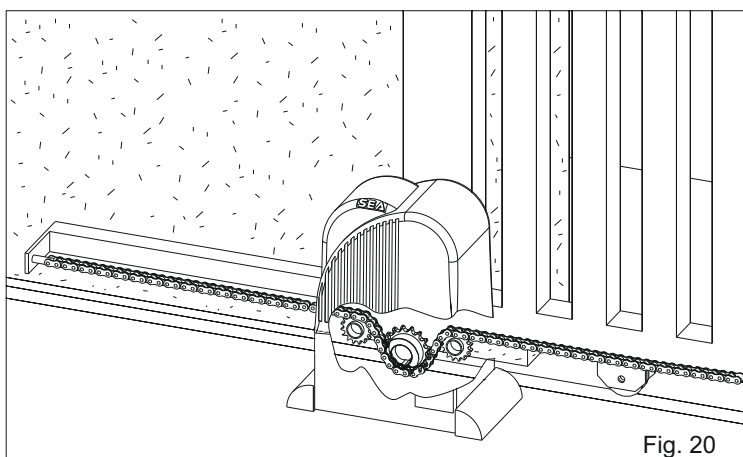

Fig. 20

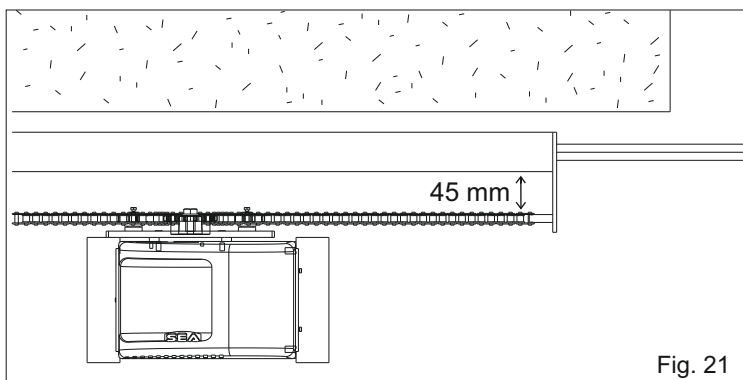

Fig. 21

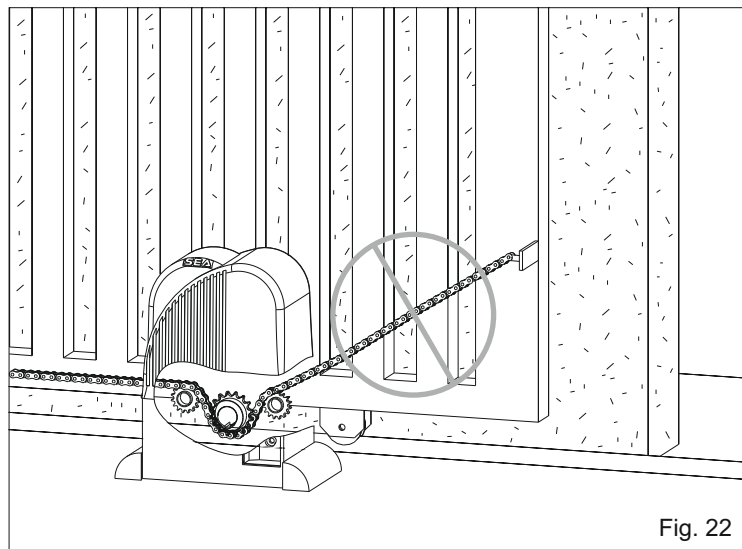

Fig. 22

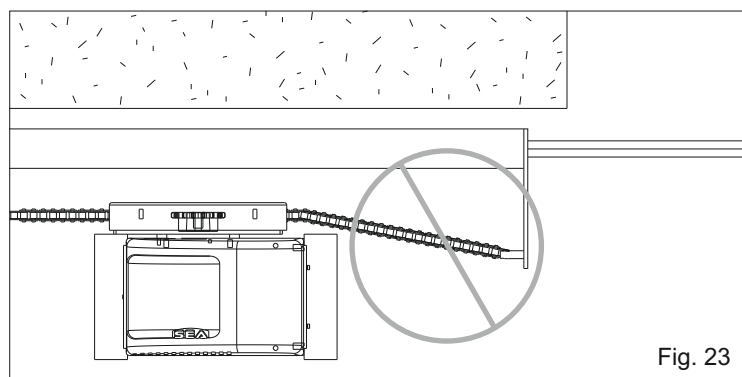

Fig. 23

## 10. EXTERNAL RELEASE (OPTIONAL)

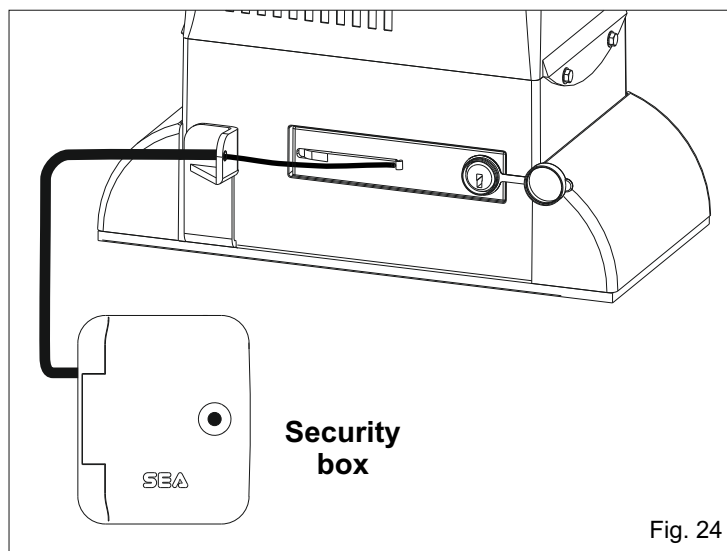

Fig. 24



## 11. BREATHER SCREW REPLACEMENT

Replace the breather screw before startup.

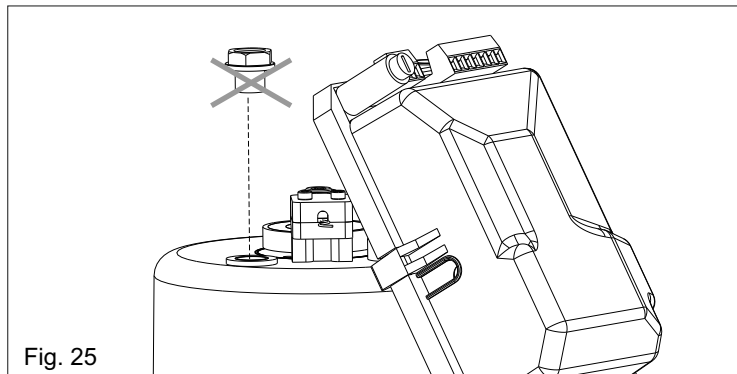

Fig. 25

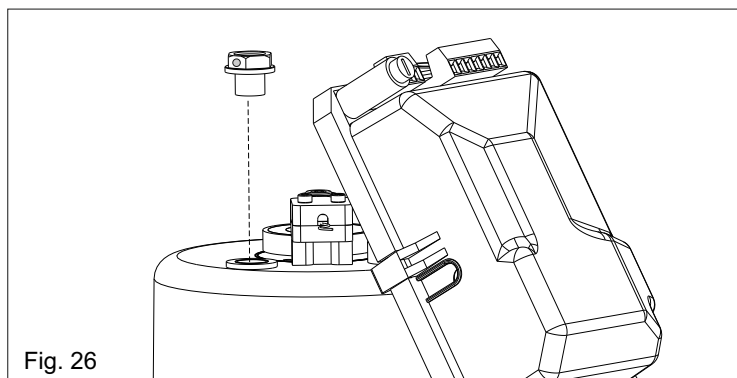

Fig. 26

## 12. BREATHER SCREW REPLACEMENT (Electrobrake version)

Replace the breather screw before startup.

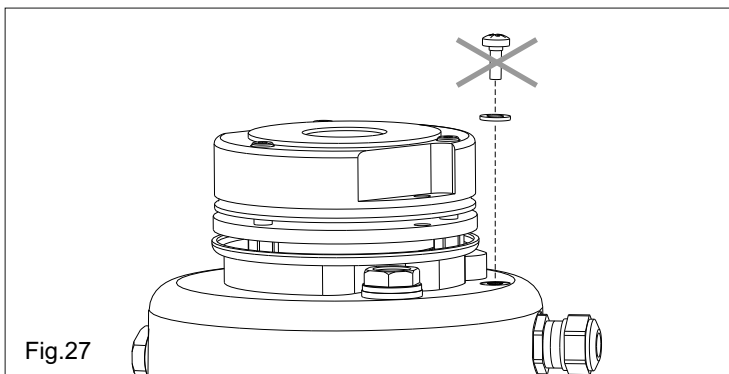

Fig. 27

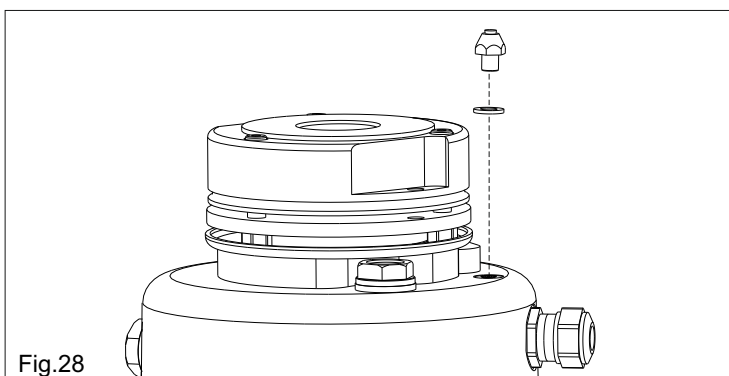
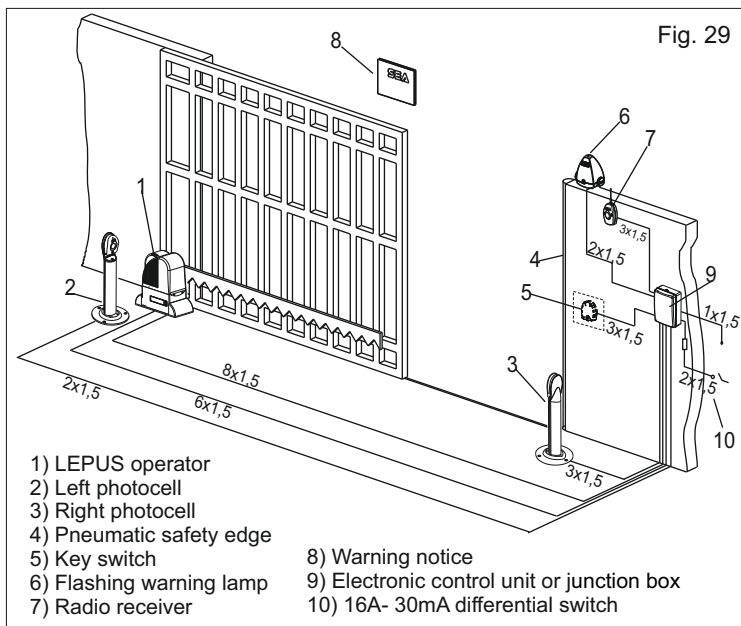

Fig. 28

## 13. CABLE LAYOUT (Fig. 29)





**Page for both instaler and user**

**14. RELEASE SYSTEM**

**14.1. In order to release do as follows:**

- Open the lock cover, insert the key and rotate it 90° clockwise (Fig. 30).
- Pull the release lever until it stops, about 90° approximately (Fig. 31).

**Note: when you pull the release lever, the electronic control unit receives a stop impulse thanks to a micro-switch placed inside.**

**14.2. In order to relock do as follows:**

- Push the release lever to complete closing.
- Rotate the key counter-clockwise and extract it.
- Close the protective lock cover.

Once the lock has been restored the electronic control unit reactivates

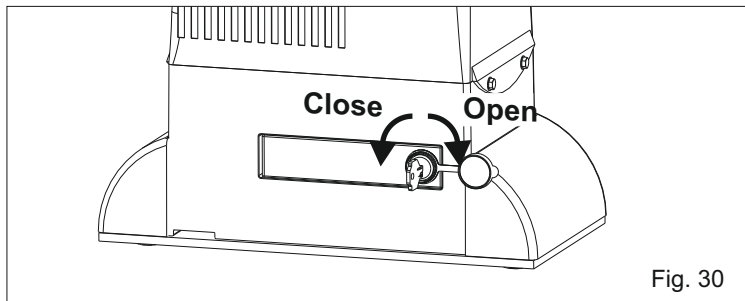

Fig. 30

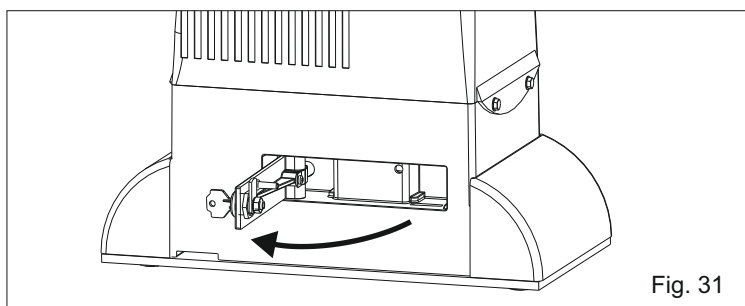

Fig. 31

**15. RISK EXAMINATION**

The points pointed by arrows in Fig. 32 are potentially dangerous. The installer must take a thorough risk examination to prevent crushing, conveying, cutting, grappling, trapping so as to guarantee a safe installation for people, things and animals (Re. Laws in force in the country where the installation has been made.)

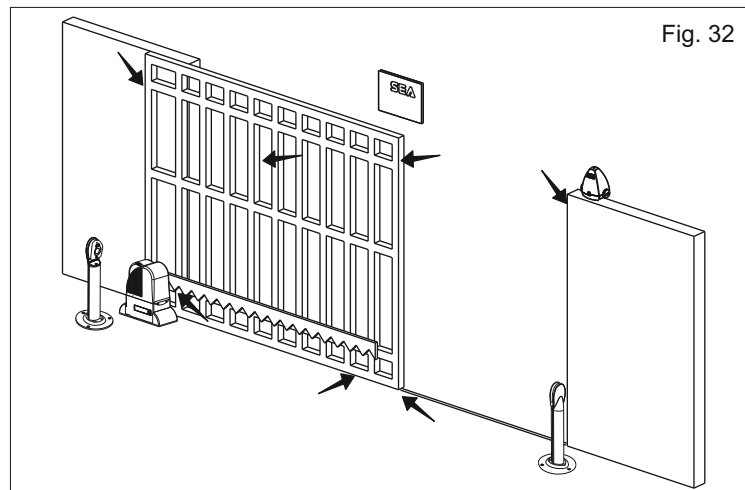

Fig. 32

**NOTICE**

SEA S.p.A. can not be deemed responsible for any damage or accident caused by product breaking, being damages or accidents due to a failure to comply with the instructions herein. The guarantee will be void and the manufacturer responsibility (according to Machine Law) will be nullified if SEA S.p.A. original spare parts are not being used.

The electrical installation shall be carried out by a professional technician who will release documentation as requested by the laws in force. This is a quotation from the GENERAL DIRECTIONS that the installer must read carefully before installing. Packaging materials such as plastic bags, foam polystyrene, nails etc must be kept out of children's reach as dangers may arise.

**SAFETY PRECAUTIONS:**

All electrical work should conform to current regulations. A 16 A 0,030 A differential switch must be incorporated into the source of the operators main electrical supply and the entire system properly earth bonded. Always run mains carrying cables in separate ducts to low voltage control cables to prevent mains interference.

**SPARE PARTS:**

To obtain spare parts contact:  
**SEA S.p.A. -Zona Ind.le, 64020 S. ATTO Teramo Italia**

**SAFETY AND ENVIRONMENTAL COMPATIBILITY:**

Don't waste product packing materials and/or circuits. When being transported this product must be properly packaged and handled with care.

**NOTE: THE MANUFACTURER CAN NOT BE DEEMED RESPONSIBLE FOR ANY DAMAGE OR INJURY CAUSED BY IMPROPER USE OF THIS PRODUCT.**

*SEA reserves the right to do changes or variations that may be necessary to its products with no obligation to notice.*

**PERIODICAL MAINTENANCE**

Check the oil level (trasparent cap placed on the side of the bell)	Annual
Change the oil	4 years
Check the release function	Annual
Check the clutch function on the gate	Annual
Check the distance between the pinion and the rack	Annual
Check the wear condition of the pinion and of the rack	Annual
Check the fixing screws	Annual
Check the integrity of the connection cables	Annual
Check the function and the limit switch condition in opening and closing and the related plates	Annual

All the above described operations must be made exclusively by an authorized installer.



## TERMS OF SALES

**EFFICACY OF THE FOLLOWING TERMS OF SALE:** the following general terms of sale shall be applied to all orders sent to SEA S.p.A. All sales made by SEA to all costumers are made under the prescription of this terms of sales which are integral part of sale contract and cancel and substitute all apposed clauses or specific negotiations present in order document received from the buyer.

**GENERAL NOTICE** The systems must be assembled exclusively with SEA components, unless specific agreements apply. Non-compliance with the applicable safety standards (European Standards EM12453 – EM 12445) and with good installation practice releases SEA from any responsibilities. SEA shall not be held responsible for any failure to execute a correct and safe installation under the above mentioned standards.

**1) PROPOSED ORDER** The proposed order shall be accepted only prior SEA approval of it. By signing the proposed order, the Buyer shall be bound to enter a purchase agreement, according to the specifications stated in the proposed order.

On the other hand, failure to notify the Buyer of said approval must not be construed as automatic acceptance on the part of SEA.

**2) PERIOD OF THE OFFER** The offer proposed by SEA or by its branch sales department shall be valid for 30 solar days, unless otherwise notified.

**3) PRICING** The prices in the proposed order are quoted from the Price List which is valid on the date the order was issued. The discounts granted by the branch sales department of SEA shall apply only prior to acceptance on the part of SEA. The prices are for merchandise delivered ex-works from the SEA establishment in Teramo, not including VAT and special packaging. SEA reserves the right to change at any time this price list, providing timely notice to the sales network. The special sales conditions with extra discount on quantity basis (Qx, Qx1, Qx2, Qx3 formula) is reserved to official distributors under SEA management written agreement.

**4) PAYMENTS** The accepted forms of payment are each time notified or approved by SEA. The interest rate on delay in payment shall be 1.5% every month but anyway shall not be higher than the max. interest rate legally permitted.

**5) DELIVERY** Delivery shall take place, approximately and not peremptorily, within 30 working days from the date of receipt of the order, unless otherwise notified. Transport of the goods sold shall be at Buyer's cost and risk. SEA shall not bear the costs of delivery giving the goods to the carrier, as chosen either by SEA or by the Buyer. Any loss and/or damage of the goods during transport, are at Buyer's cost.

**6) COMPLAINTS** Any complaints and/or claims shall be sent to SEA within 8 solar days from receipt of the goods, proved by adequate supporting documents as to their truthfulness.

**7) SUPPLY** The concerning order will be accepted by SEA without any engagement and subordinately to the possibility to get it's supplies of raw material which is necessary for the production; Eventual completely or partially unsuccessful executions cannot be reason for complains or reservations for damage. SEA supply is strictly limited to the goods of its manufacturing, not including assembly, installation and testing. SEA, therefore, disclaims any responsibility for damage deriving, also to third parties, from non-compliance of safety standards and good practice during installation and use of the purchased products.

**8) WARRANTY** The standard warranty period is 12 months. This warranty time can be extended by means of expedition of the warranty coupon as follows:

**SILVER:** The mechanical components of the operators belonging to this line are guaranteed for 24 months from the date of manufacturing written on the operator.

**GOLD:** The mechanical components of the operators belonging to this line are guaranteed for 36 months from the date of manufacturing written on the operator.

**PLATINUM:** The mechanical components of the operators belonging to this line are guaranteed for 36 months from the date of manufacturing written on the operator. The base warranty (36 months) will be extended for further 24 months (up to a total of 60 months) when it is acquired the certificate of warranty which will be filled in and sent to SEA S.p.A. The electronic devices and the systems of command are guaranteed for 24 months from the date of manufacturing. In case of defective product, SEA undertakes to replace free of charge or to repair the goods provided that they are returned to SEA repair centre. The definition of warranty status is by unquestionable assessment of SEA. The replaced parts shall remain propriety of SEA. Binding upon the parties, the material held in warranty by the Buyer, must be sent back to SEA repair centre with fees prepaid, and shall be dispatched by SEA with carriage forward. The warranty shall not cover any required labour activities.

The recognized defects, whatever their nature, shall not produce any responsibility and/or damage claim on the part of the Buyer against SEA. The guarantee is in no case recognized if changes are made to the goods, or in the case of improper use, or in the case of tampering or improper assembly, or if the label affixed by the manufacturer has been removed including the SEA registered trademark No. 804888. Furthermore, the warranty shall not apply if SEA products are partly or completely coupled with non-original mechanical and/or electronic components, and in particular, without a specific relevant authorization, and if the Buyer is not making regular payments. The warranty shall not cover damage caused by transport, expendable material, faults due to non-conformity with performance specifications of the products shown in the price list. No indemnification is granted during repairing and/or replacing of the goods in warranty. SEA disclaims any responsibility for damage to objects and persons deriving from non-compliance with safety standards, installation instructions or use of sold goods. The repair of products under warranty and out of warranty is subject to compliance with the procedures notified by SEA.

**9) RESERVED DOMAIN** A clause of reserved domain applies to the sold goods; SEA shall decide autonomously whether to make use of it or not, whereby the Buyer purchases propriety of the goods only after full payment of the latter.

**10) COMPETENT COURT OF LAW** In case of disputes arising from the application of the agreement, the competent court of law is the tribunal of Teramo. SEA reserves the faculty to make technical changes to improve its own products, which are not in this price list at any moment and without notice. SEA declines any responsibility due to possible mistakes contained inside the present price list caused by printing and/or copying. The present price list cancels and substitutes the previous ones. The Buyer, according to the law No. 196/2003 (privacy code) consents to put his personal data, deriving from the present contract, in SEA archives and electronic files, and he also gives his consent to their treatment for commercial and administrative purposes.

**Industrial ownership rights:** once the Buyer has recognized that SEA has the exclusive legal ownership of the registered SEA brand num.804888 affixed on product labels and / or on manuals and / or on any other documentation, he will commit himself to use it in a way which does not reduce the value of these rights, he won't also remove, replace or modify brands or any other particularity from the products. Any kind of replication or use of SEA brand is forbidden as well as of any particularity on the products, unless preventive and expressed authorization by SEA.

**In accomplishment with art. 1341 of the Italian Civil Law it will be approved expressly clauses under numbers:**

**4) PAYMENTS - 8) GUARANTEE - 10) COMPETENT COURT OF LAW**

**English GENERAL NOTICE FOR THE INSTALLER AND THE USER**

1. Read carefully these **Instructions** before beginning to install the product. Store these instructions for future reference
2. Don't waste product packaging materials and /or circuits.
3. This product was designed and built strictly for the use indicated in this documentation. Any other use, not expressly indicated here, could compromise the good condition/operation of the product and/or be a source of danger. SEA S.p.A. declines all liability caused by improper use or different use in respect to the intended one.
4. The mechanical parts must be comply with Directives: Machine Regulation 2006/42/CE and following adjustments), Low Tension (2006/95/CE), electromgnetic Consistency (2004/108/CE) Installation must be done respecting Directives: EN12453 and En12445.
5. Do not install the equipment in an explosive atmosphere.
6. SEA S.p.A. is not responsible for failure to observe Good Techniques in the construction of the locking elements to motorize, or for any deformation that may occur during use.
7. Before attempting any job on the system, cut out electrical power and disconnect the batteries. Be sure that the earthing system is perfectly constructed, and connect it metal parts of the lock.
8. Use of the indicator-light is recommended for every system, as well as a warning sign well-fixed to the frame structure.
9. SEA S.p.A. declines all liability as concerns the automated system's security and efficiency, if components used, are not produced by SEAS.p.A..
10. For maintenance, strictly use original parts by SEA.
11. Do not modify in any way the components of the automated system.
12. The installer shall supply all information concerning system's manual functioning in case of emergency, and shall hand over to the user the warnings handbook supplied with the product.
13. Do not allow children or adults to stay near the product while it is operating. The application cannot be used by children, by people with reduced physical, mental or sensorial capacity, or by people without experience or necessary training. Keep remote controls or other pulse generators away from children, to prevent involuntary activation of the system.
14. Transit through the leaves is allowed only when the gate is fully open.
15. The User must not attempt to repair or to take direct action on the system and must solely contact qualified SEA personnel or SEA service centers. User can apply only the manual function of emergency.
16. The power cables maximum length between the central engine and motors should not be greater than 10 m. Use cables with 2,5 mm<sup>2</sup> section. Use double insulation cable (cable sheath) to the immediate vicinity of the terminals, in particular for the 230V cable. Keep an adequate distance (at least 2.5 mm in air), between the conductors in low voltage (230V) and the conductors in low voltage safety (SELV) or use an appropriate sheath that provides extra insulation having a thickness of 1 mm.



**Dichiarazione di conformità  
Declaration of Conformity**

**La SEA S.p.A. dichiara che, con l'installazione degli adeguati dispositivi di sicurezza e di filtraggio disturbi, i prodotti:**

**SEA S.p.A. declares that by installing the appropriate safety equipment and noise filtering the products:**

<i>Descrizione / Description</i>	<i>Modello / Model</i>	<i>Marca / Trademark</i>
<b>LEPUS 600</b> (e tutti i suoi derivati / and all its by-products)	<b>11102025/30/35/38</b>	<b>SEA</b>
<b>LEPUS 1600</b> (e tutti i suoi derivati / and all its by-products)	<b>11110305/00</b>	<b>SEA</b>
<b>LEPUS 2000 TRIFASE</b> (e tutti i suoi derivati / and all its by-products)	<b>11110505/00</b>	<b>SEA</b>

**sono costruiti per essere incorporati in una macchina o per essere assemblati con altri macchinari per costruire una macchina ai sensi della Direttiva 2006/42/CE:**

*are built to be integrated into a machine or to be assembled with other machinery to create a machine under the provisions of Directive 2006/42/CE:*

*sono conformi ai requisiti essenziali di sicurezza relativi al prodotto entro il campo di applicabilità delle Direttive Comunitarie 2006/95/CE e 2004/108/CE.*

*are conforming to the essential safety requirements related to the product within the field of applicability of the Community Directives 2006/95/CE and 2004/108/CE.*

**COSTRUTTORE o RAPPRESENTANTE AUTORIZZATO:**  
**MANUFACTURER or AUTHORISED REPRESENTATIVE:**

SEA S.p.A.

DIREZIONE E STABILIMENTO:

Zona industriale 64020 S.ATTO Teramo - (ITALY)

Tel. +39 0861 588341 r.a. Fax +39 0861 588344

Http://www.seateam.com

I test sul prodotto sono stati effettuati in configurazione standard e in riferimento alle norme specifiche per la sua classe d'utilizzo.

The products have been tested in standard configuration and with reference to the special norms concerning the classe of use.

(Luogo, data di emissione)

(Place, date of issue)

Teramo, 10/12/2012

L'Amministratore  
The Administrator  
Ennio Di Saverio



## Automatic Gate Openers

Questo articolo è stato prodotto seguendo rigide procedure di lavorazione ed è stato testato singolarmente al fine di garantire i più alti livelli qualitativi e la vostra soddisfazione. Vi ringraziamo per aver scelto SEA.

This item has been produced following strict production procedures and has been singularly tested for the highest quality levels and for your complete satisfaction.  
Thanks for choosing SEA.

Cet article a été produit suivant des procédures d'usinage strictes et il a singulièrement été testé afin de garantir les plus hauts niveaux de qualité pour votre satisfaction.  
Nous vous remercions d'avoir choisi SEA.

Este artículo ha sido producido siguiendo rigidos procedimientos de elaboración y ha sido probando singolarmente a fin de garantizar los mas altos niveles de calidad y vuestra satisfaccion.  
Le agradecemos por haber escogito SEA.









**Automatic Gate Openers**

International registered trademark n. 804888

**SEA S.p.A.**

**Zona industriale 64020 S.ATTO Teramo - (ITALY)**

**Tel. +39 0861 588341 r.a. Fax +39 0861 588344**

**[www.seateam.com](http://www.seateam.com)**

**[seacom@seateam.com](mailto:seacom@seateam.com)**